



Thank you for your purchase!



Instructions made easy
Read instructions or watch an easy-to-follow video.



Register your product
Receive exclusive deals and register your product.

Scan code or visit byjasco.com/49895i Scan code or visit byjasco.com/deals.

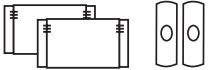

Need more accessories?
For additional Philips doorbell receivers, push buttons and more, visit our website! byjasco.com/chimes

Like our product?
Leave a review on your favorite retailer website or amazon.com.

Having problems?
Let us know how we can help.
Call 1-844-816-0320, M-F.



MADE IN CHINA

Philips and the Philips Shield Emblem are registered trademarks of Koninklijke Philips N.V. and are used under license. This product has been manufactured by and is sold under the responsibility of Jasco Products Company, and Jasco Products Company LLC, 10 E. Memorial Rd., Oklahoma City, OK 73114 is the warrantor in relation to this product.

This product has a 1-year limited warranty. Visit www.philips.com/support for warranty details.

Questions? Contact our U.S.-based Consumer Care at 1-844-816-0320, M-F.

PATENTS/PATENTS PENDING WWW.BYJASCO.COM/PATENT





DES1120W/27
v3 09/2025

Doorbell kit

Chimes



Suppliers Declaration of Conformity | Model #: DE51 120W/27
Jasco Products Co., 10 E. Memorial Rd., Oklahoma City, OK 73114, www.byjasco.com.

This device complies with Part 15 of the FCC rules. Operation is subject to the following two conditions: (1) this device may not cause harmful interference, and (2) this device must accept any interference received, including interference that may cause undesired operation.

FCC NOTE: The manufacturer is not responsible for any radio or TV interference caused by unauthorized modifications to this equipment. Such modifications could void the user's authority to operate the equipment.

NOTE: This equipment has been tested and found to comply with the limits for a Class B digital device, pursuant to Part 15 of the FCC Rules. These limits are designed to provide reasonable protection against harmful interference to radio frequency energy and, if not installed and used in accordance with the instructions, may cause harmful interference to radio communications. However, there is no guarantee that interference will not occur in a particular installation. If this equipment does cause harmful interference to radio or television reception, which can be determined by turning the equipment off and on, the user is encouraged to try to correct the interference by one of the following measures:

- Reorient or relocate the receiving antenna.
- Increase the separation between the equipment and receiver.
- Connect the equipment into an outlet on a circuit different from that to which the receiver is connected.
- Consult the dealer or an experienced radio/TV technician for help.

*Functional range may be adversely affected by one or more of the following factors: weather, radio frequency interference, low transmitter battery or obstructions between the transmitter and receiver.

Temporary installation

1. Clean the mounting location for the push button with a mixture of 50% water and 50% isopropyl alcohol.
2. Remove protective backing from one side of the adhesive pad and attach it to the back plate of the push button.
3. Remove protective backing from the other side of the adhesive pad and press the back plate to the cleaned mounting location. Hold in place for a few seconds to allow for a secure bond.

If the doorbell does not work:

- Make sure push button switch is pressed down and held for at least 1 second.
- Verify battery installation is correct (check polarity).
- Try a fresh battery in push button.
- Make sure doorbell is no farther than 150 feet from the push button*.
- Ensure push button is not mounted on metal, near metal studs or near the floor.
- Try a new location for the doorbell.
- Try a new location for the doorbell.
- If the doorbell and push button(s) still do not operate, repeat the electronic pairing process of the push button(s) to the doorbell listed below.
- a. To clear settings: press and hold the pairing button on the bottom of the doorbell while installing the third battery.
- b. Once the last battery is installed, release the pairing button.
- c. Press and hold the pairing button again. You will hear the "ding-dong" melody twice, and then the double beep to alert you the doorbell is ready to pair with the push button. Release the pairing button.
- d. Press and release the push button. (Fig. 5) You will hear one beep letting you know the doorbell accepted the signal.
- e. Wait 10 seconds, and you will hear the double beep again to alert you the doorbell is paired with the push button.
- f. Press the push button to test.

V. Mounting instructions cont.

V. Mounting instructions

I. Doorbell kit components

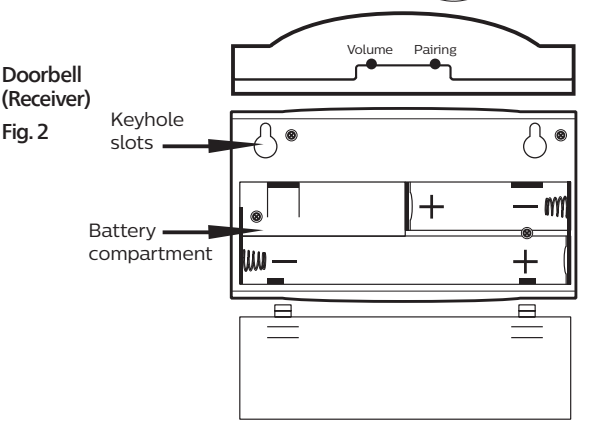
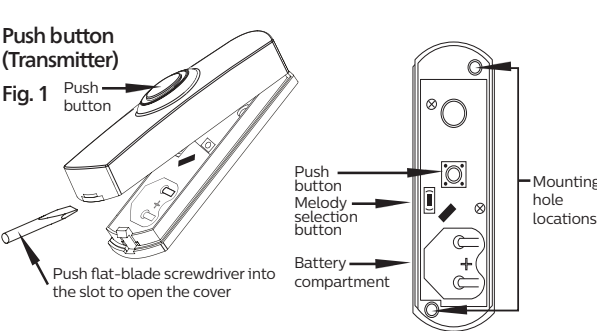

Items required for installation and use (not included)

- #2 Phillips screwdriver
- 1/16 in. and 3/32 in. drill bits
- Small flat-blade screwdriver
- 3 AA batteries

A. Doorbell (receiver) mounting
NOTE: The doorbell mounting hole template is included on this page for your convenience.

NOTE: Avoid mounting on metal surfaces, as it may result in a reduced range of reception.

1. Select doorbell mounting location.
2. Using the doorbell mounting template below, drill two holes with a 3/32 in. drill bit in marked keyhole slot locations (Fig. 2).
3. Insert the two 3x25 mm screws included into the holes setting the screw heads extending about 1/4 in. from mounting surface.
4. Place the doorbell unit's keyhole slots over the screws and press down on the doorbell unit to secure it.

B. Push button (transmitter) mounting

NOTE: Avoid mounting on metal surfaces, as it may result in a reduced range of transmission. Do not mount in an area exposed to direct rain. Push buttons are typically mounted at the same height as the doorknob or handle.

1. Remove the front cover of the push button (Fig. 1).
2. Before mounting, choose a mounting location within 150 ft. of the doorbell unit location. Place the push button where you would like to mount and test with the doorbell as close to its final location as possible. If it works, continue with mounting the button. If it does not work, see TROUBLESHOOTING.
3. Hold the back plate of the push button in the selected location with the arrow on the back of the back plate pointing up.
4. Using the 1/16 in. drill bit, drill a hole through the back plate of the push button (Fig. 1) and into the surface of the selected location.
5. Secure with the two screws provided.
6. Press front housing onto back cover.
7. Test operation. If doorbell does not work, see TROUBLESHOOTING.

Permanent installation

MOUNTING TEMPLATE
Doorbell receiver

7.5 cm

II. Battery installation cont.

II. Battery installation

A. Doorbell (receiver)

1. Remove the cover of the doorbell battery compartment (Fig. 2) and install 3 AA batteries (not included) noting correct polarity.

B. Push button (transmitter)

NOTE: Push button has CR2032 battery is installed — the battery isolation tab must be removed prior to use.

1. Remove the front cover of the push button housing by pushing a flat-blade screwdriver into the slot at the bottom of the push button housing (Fig. 1).
2. Replace the CR2032 battery with the positive (+) side up. Note: Keep the front cover off of the push button until melody selection is complete.

The doorbell and push button(s) are electronically paired during production. Once the batteries are installed in the push button and doorbell receiver, press the push button(s) to ensure the push button(s) cause the doorbell to operate. If doorbell chime does not sound when the batteries are installed and the push button is pressed, see Troubleshooting section.

NOTE:

- Ensure the batteries are installed correctly according to polarity (+ and -).
- Do not mix old and new batteries, different brands or types of batteries, such as alkaline, carbon-zinc or rechargeable batteries.
- Remove and immediately recycle or dispose of batteries from equipment not used for an extended period according to local regulations.
- Always completely secure the battery compartment. If the battery compartment does not close securely, stop using the product, remove the batteries and keep them away from children.

C. Included battery

- Battery type CR2032, 3 V
- Remove and immediately recycle or dispose of used batteries according to local regulations and keep away from children. Do NOT dispose of batteries in household trash or incinerate.
- Even used batteries may cause severe injury or death.
- Call a local poison control center for treatment information.
- Non-rechargeable batteries are not to be recharged.
- Do not force discharge, recharge, disassemble, heat above 60° C (140° F) or incinerate. Doing so may result in injury due to venting, leakage or explosion resulting in chemical burns.

To select one of the four volume settings:

1. Press and release the pairing button on the doorbell or push the push button to play the melody.
2. While melody is playing, press and release the volume button to select the desired sound level.

IV. Volume adjustment

To select the melody for your doorbell:

1. Push the **Melody Selection Button** inside the push button housing. (Fig. 3)
2. Press and release the melody selection button until you hear the desired melody. The last melody played will be your selected doorbell melody.

Melody playlist:

- 1 Ding-dong
- 2 Westminster

III. Melody selection setting

⚠ WARNING

- **Ingestion hazard:** This product contains a button cell or coin battery.
- **DEATH** or serious injury can occur if ingested.
- A swallowed button cell or coin battery can cause **Internal Chemical Burns** in as little as **2 hours**.
- **KEEP** new and used batteries **out of reach of children**.
- **Seek immediate medical attention** if a battery is suspected to be swallowed or inserted inside any part of the body.



Fig. 4



Fig. 3





¡Gracias por su compra!



Instrucciones fáciles

Lea las instrucciones o mire el video con el paso a paso.

Escanee el código o visite byjasco.com/498951



Registre su producto

Recibe ofertas exclusivas y registra tu producto.

Escanee el código o visite byjasco.com/deals

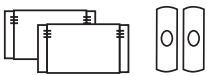

¿Necesita más accesorios?

Para ver más receptores, botones táctiles y muchos más productos Philips, visite nuestro sitio web.

byjasco.com/lighting



¿Le gusta nuestro producto?

Deje una reseña en el sitio web de su distribuidor favorito o en amazon.com.



¿Tiene algún problema?

Díganos cómo podemos ayudar. Llame al **1-844-816-0320**, de lunes a viernes.



HECHO EN CHINA

Philips y el emblema de escudo Philips son marcas registradas de Koninklijke Philips N.V. y se usan bajo licencia. Este producto ha sido fabricado y se comercializa bajo responsabilidad de Jasco Products Company y Jasco Products Company LLC, 10 E. Memorial Rd., Oklahoma City, OK 73114 es el garante en relación a este producto.

Este producto tiene una garantía 1 año limitado. Visite www.philips.com/support para conocer los detalles de la garantía. ¿Tiene preguntas? Comuníquese con nuestro servicio de atención al consumidor de EE. UU. al 1-844-816-0320, de lunes a viernes.

PATENTES/PATENTES PENDIENTES WWW.BYJASCO.COM/PATENTS

I. Componentes del kit de timbre

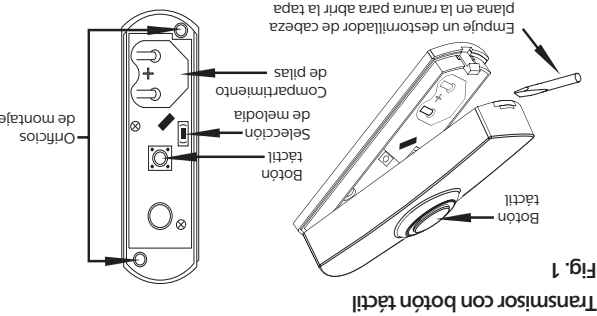

Receptor de timbre

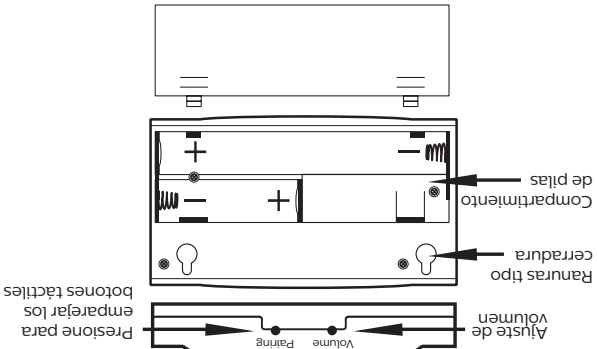

- Destornillador Phillips no. 2
- Brocas de 1/16 pulg. y 3/32 pulg.
- Tres pilas AA
- Cabeza plana

Elementos necesarios para la instalación y el uso (no incluidos)

II. Colocación de Las pilas

V. Instrucciones de montaje

Instalación temporal

1. Limpie la ubicación de montaje del botón táctil con una mezcla de un 50 % de agua y un 50 % de alcohol isopropílico.
2. Retire el papel protector de un lado de la almohadilla adhesiva y únala a la placa posterior del botón táctil.
3. Retire el papel protector del otro lado de la almohadilla adhesiva y presione la placa posterior a la ubicación de montaje limpia. Sujete en el lugar durante unos segundos para que se adhiera firmemente.

VI. Solución de problemas

Si el timbre no funciona...

- Asegúrese de que el interruptor del botón táctil se presione y sostenga durante, al menos, 1 segundo.
- Verifique que las pilas estén colocadas correctamente (revise los polos).
- Intente colocar una pila nueva en el botón táctil.
- Asegúrese de que el timbre esté a no más de 46 metros (150 pies) desde el botón táctil*.
- Asegúrese de que el botón táctil no esté montado sobre metal, cerca de travesaños metálicos o cerca del piso.
- Pruebe instalar el timbre en otra ubicación.
- Si el timbre y los botones táctiles siguen sin funcionar, repita el siguiente proceso de emparejamiento electrónico de los botones táctiles con el timbre.
 - a. Para borrar la configuración: mantenga presionado el botón de emparejamiento en la parte inferior del timbre mientras coloca la tercera pila.
 - b. Cuando se haya colocado la última pila, suelte el botón de emparejamiento.
 - c. Nuevamente, mantenga presionado el botón de emparejamiento. Escuchará la melodía “ding dong” dos veces y, luego, el pitido doble que le avisará que el timbre está listo para emparejarse con el botón táctil. Suelte el botón de emparejamiento.
 - d. Presione y suelte el botón táctil. (Fig. 5) Escuchará un pitido que le avisará que el timbre aceptó la señal.

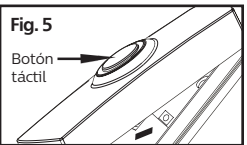

II. Colocación de las pilas cont.

V. Instrucciones de montaje

A. Montaje del timbre (receptor)

La plantilla del orificio de montaje del timbre se incluye en esta página para su comodidad.

NOTA: Evite realizar el montaje en superficies metálicas, ya que puede causar una reducción del rango de recepción.

1. Seleccione la ubicación de montaje del timbre.
2. Usando la plantilla de montaje del timbre que se muestra a continuación, taladre dos orificios con una broca de 3/32 pulg. en las ubicaciones de las ranuras tipo cerradura marcadas (Fig. 2).
3. Inserte en los orificios los dos tornillos de 3 x 25 mm que se incluyen, dejando las cabezas de los tornillos asomadas a 1/4 pulg. de la superficie de montaje.
4. Coloque las ranuras tipo cerradura de la unidad del timbre sobre los tornillos y presione la unidad del timbre para fijarla.

B. Montaje del botón táctil (transmisor)

NOTA: Evite realizar el montaje en superficies metálicas, ya que puede causar una reducción del rango de transmisión. No monte en un área expuesta a lluvia directa. Los botones táctiles se montan típicamente a la misma altura de la perilla o manija de la puerta (entre 91 cm (36 pulg.) y 1.1 m (44 pulg.) sobre el piso).

Instalación permanente

1. Retire la tapa del botón táctil (Fig. 1).
2. Antes de montar, elija una ubicación de montaje que esté a no más de 46 metros (150 pies) de la ubicación de la unidad de timbre. Coloque el botón táctil donde desee montarlo y próbarlo con el timbre tan cerca a su ubicación final como sea posible. Si funciona, continúe el montaje del botón. Si no funciona, consulte la SOLUCIÓN DE PROBLEMAS.
3. Sujete la placa posterior del botón táctil en la ubicación seleccionada con la flecha de la parte posterior apuntando hacia arriba.
4. Con la broca de 1/16 pulg., taladre un orificio que traspase la placa posterior del timbre (Fig. 1) y que perfore la superficie de la ubicación seleccionada.
5. Ajuste con los dos tornillos provistos.
6. Presione el recinto delantero sobre la tapa posterior.

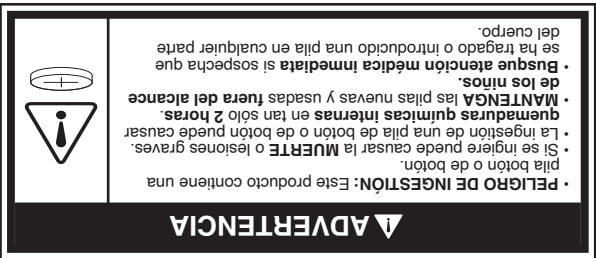

III. Configuración de selección de melodía

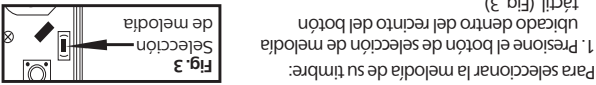

1. Presione el botón de selección de melodía de su timbre:
 1. Presione y suelte el botón de selección de melodía hasta que escuche la melodía deseada. La última melodía que suene será la seleccionada para el timbre.
 2. Mientras suena la melodía, presione y suelte el botón de sonido seleccionado.
2. Mientras suena la melodía, presione y suelte el botón de selección de melodía deseada. La última melodía que suene será la seleccionada para el timbre.

IV. Ajuste de volumen



1. Presione y suelte el botón de emparejamiento en el timbre o presione el botón táctil para que suene la melodía.
2. Mientras suena la melodía, presione y suelte el botón de sonido seleccionado.