

# Thank you for your purchase!

Instructions  
made easy



Read instructions or watch  
an easy-to-follow video.

Scan code or visit  
[byjasco.com/82573i](http://byjasco.com/82573i).

Register your  
product



Receive exclusive deals and  
register your product.

Scan code or visit  
[byjasco.com/deals](http://byjasco.com/deals).



Discover more innovative  
lighting at [byjasco.com](http://byjasco.com)



**Like our product?**

Leave a review  
on your favorite  
retailer website or  
[amazon.com](http://amazon.com).



**Having problems?**

Let us know how  
we can help. Call  
**1-800-654-8483**,  
Monday-Friday

# Swivel Sconce LED Night Light

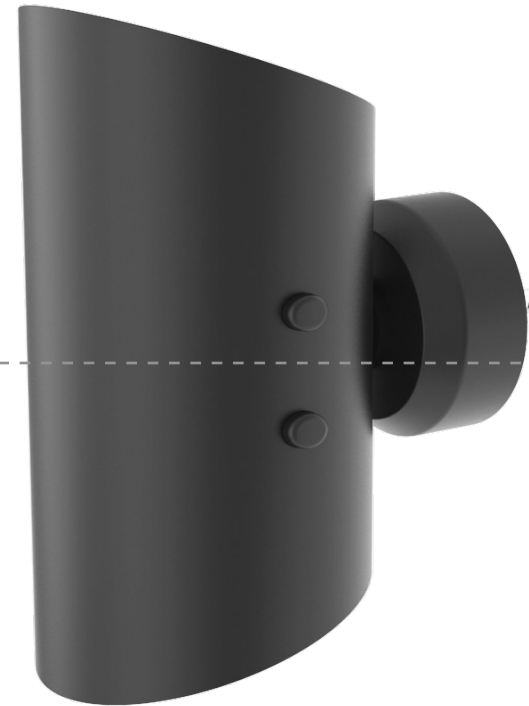

Model# 82573

See reverse for easy-to-follow  
instructions and exclusive deals.

# Instructions

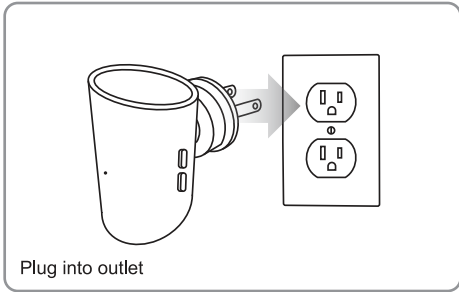

## PLUG IN

Plug the night light into a grounded wall outlet.

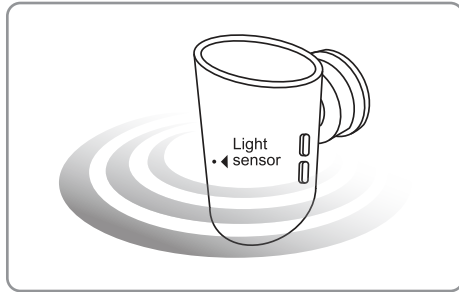

## LIGHT SENSING

The light automatically turns on when the room is dark and off when the room is lit.

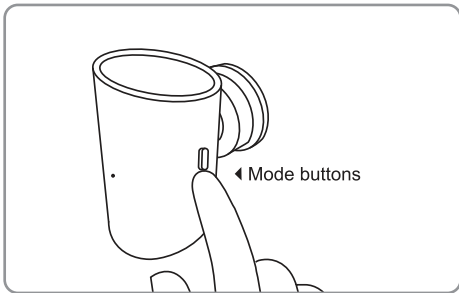

## CHOOSE A MODE

Each LED is independently controlled by its own button. Press and release to choose your favorite color mode.

- |                         |                |
|-------------------------|----------------|
| 1. White light          | 10. Light blue |
| 2. Automatic color fade | 11. Purple     |
| 3. Red                  | 12. Violet     |
| 4. Green                | 13. Pink       |
| 5. Blue                 | 14. Hot pink   |
| 6. Orange               | 15. OFF        |
| 7. Yellow               |                |
| 8. Light green          |                |
| 9. Teal                 |                |

**DIMMING:** Press and hold the button in any single-color mode — the LED will blink when the highest or lowest brightness is reached.

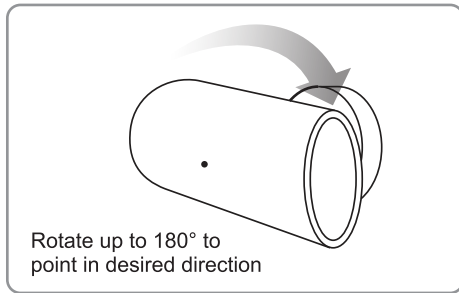

## ROTATE LEDs

Rotate the night light up to 180° to point the LEDs in the desired direction. **IMPORTANT:** Do not force the rotation, as it can damage the night light.

# Instrucciones

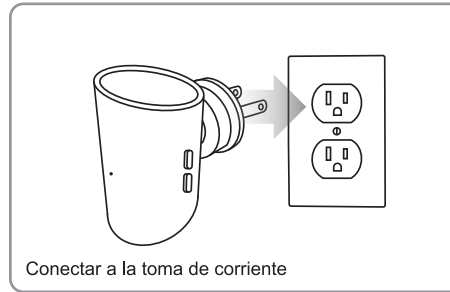

## ENCHUFAR

Enchufe la luz nocturna en un tomacorriente de pared con conexión a tierra.

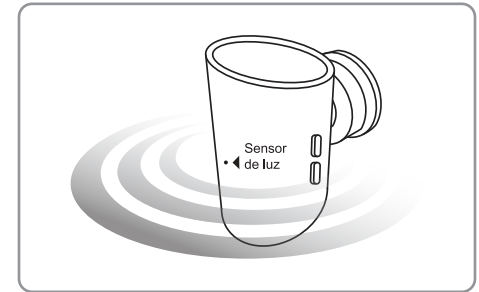

## SENSIBLE A LA LUZ

La luz se enciende automáticamente cuando la habitación está oscura y se apaga cuando la habitación está iluminada.

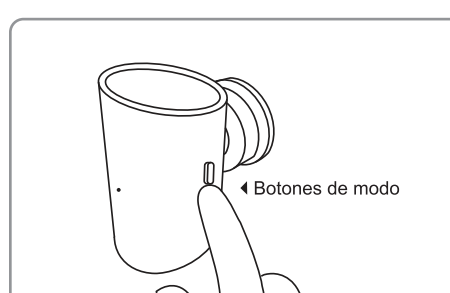

## ELIJA UN MODO

Cada LED se controla de forma independiente mediante su propio botón. Presione y suelte para elegir su modo de color favorito.

- |  |                    |
|--|--------------------|
| 1. Luz blanca                          | 9. Verde azulado   |
| 2. Desvanecimiento de color automático | 10. Celeste        |
| 3. Rojo                                | 11. Morado         |
| 4. Verde                               | 12. Violeta        |
| 5. Azul                                | 13. Rosa           |
| 6. Naranja                             | 14. Rosa brillante |
| 7. Amarillo                            | 15. OFF            |
| 8. Verde claro                         |                    |

**ATENUACION:** Mantenga presionado el botón en cualquier modo de un solo color: el LED parpadeará cuando se alcance el brillo más alto más bajo.

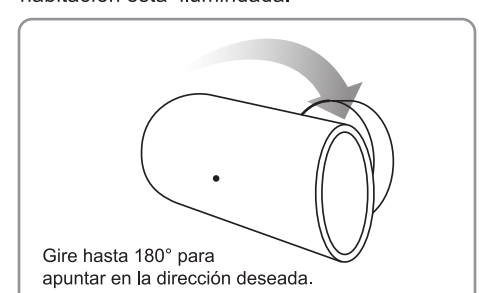

## GIRAR LED

Gire la luz nocturna 180° para apuntar los LED en la dirección deseada. **IMPORTANTE:** No fuerces el giro, ya que puedes dañar la luz nocturna.



Intertek

PATENTS/PATENTS PENDING  
WWW.BYJASCO.COM/PATENTS

MADE IN CAMBODIA

GE is a trademark of General Electric Company and is under license by Jasco Products Company LLC, 10 E. Memorial Rd., Oklahoma City, OK 73114.

This Jasco product has a 1-year limited warranty. Visit [www.byjasco.com](http://www.byjasco.com) for warranty details.

Questions? Contact our U.S.-based Consumer Care at 1-800-654-8483, M-F.



[byjasco.com/recycle](http://byjasco.com/recycle)  
paper made from 25% post-consumer-waste

## WARNING

### RISK OF ELECTRIC SHOCK

- THIS PRODUCT IS NOT A TOY AND IS NOT INTENDED FOR USE BY CHILDREN
- FOR ADULTS ONLY
- DO NOT USE WITH EXTENSION CORDS
- USE INDOORS ONLY
- NOT FOR USE IN WET OR DAMP LOCATIONS

### RISK OF FIRE

- PLUG ONLY IN EXPOSED WALL OUTLETS WHERE NIGHT LIGHT IS VENTILATED AND CANNOT CONTACT BED COVERINGS OR OTHER MATERIAL THAT MIGHT PRESENT A FIRE HAZARD
- DO NOT PLUG INTO DC-TO-AC POWER INVERTER SYSTEMS OR DIMMER-CONTROLLED RECEPTACLES

PATENTES/PATENTS PENDIENTES  
WWW.BYJASCO.COM/PATENTS

HECHO EN CAMBOYA

GE es una marca comercial de General Electric Company con licencia otorgada a Jasco Products Company LLC, 10 E. Memorial Rd., Oklahoma City, OK 73114.

Este producto de Jasco tiene una garantía limitada de 1 año. Visite [www.byjasco.com](http://www.byjasco.com) para conocer los detalles de la garantía.

¿Tiene preguntas? Comuníquese con nuestro servicio de atención al consumidor de EE. UU. al 1-800-654-8483, de lunes a viernes.

## ADVERTENCIA

### RIESGO DE SACUDIDA ELÉCTRICA

- ESTE PRODUCTO NO ES UN JUGUETE Y NO ES PARA USO DE INFANTES
- PARA USO DE ADULTOS ÚNICAMENTE
- NO USE CON CORDONES DE EXTENSIÓN
- PARA USO INTERIOR ÚNICAMENTE
- NO UTILIZAR EN LUGARES HUMEDOS O MOJADOS

### RIESGO DE INCENDIO

- ENCHUFE SOLAMENTE EN TOMAS DE PARED DONDE LA LUZ NOCTURNA TENGA VENTILACIÓN Y NO ENTRE EN CONTACTO CON ROPA DE CAMA U OTROS MATERIALES QUE PUEDAN REPRESENTAR RIESGO DE INCENDIO
- NO ENCHUFAR EN SISTEMAS DE INVERSORES DE ALIMENTACIÓN DE CC-A-CA, NI EN TOMACORRIENTES CONTROLADOS POR ATENUADORES